

The Essex County Council (Braintree District) (Prohibition of Waiting, Loading and Stopping) and (On-Street Parking Places) (Civil Enforcement Area) (Amendment Number 4) Order 202*

Notice is hereby given Colchester Borough Council acting on behalf of the North Essex Parking Partnership in exercise of the delegated powers of the traffic authority Essex County Council granted under an Agreement dated 31 March 2011 proposes to make the above Order under Sections 1(1), 2(1) to (3), 4 (1), 4(2), 32, 35,45,46,49 and 53 and Parts III and IV of schedule 9 of the Road Traffic Regulation Act 1984

The effect of the Order:

- 1.To introduce and revoke restrictions in the Braintree District as follows: to introduce 'No Waiting At Any Time' on Chipping Dell, Church Hill and Galleys Corner, Braintree Road; to revoke No waiting and replace with 'No Waiting At Any Time' on The Street and Bellingham Place; to revoke No waiting and replace with 'No Waiting Mon-Fri 11.30am-12.30pm and 2.30pm-3.30pm' on The Paddocks; to introduce 'Resident Permit Parking Only K4' on Bellingham Place; to revoke unrestricted parking bays and Introduce 'Resident Permit Parking Only RR1' on Rayne Road; to introduce 'Limited Waiting Mon-Sat 2 hours No Return Within 4 hours' on Galleys Corner, Braintree Road.
2. To amend Schedule 3 in The Essex County Council (Braintree District) (Prohibition of Waiting, Loading and Stopping) and (On-Street Parking Places) (Civil Enforcement Area) Order 2020 to append the items set out in Schedule 1 of this notice.
- 3.To amend Schedule 5 in The Essex County Council (Braintree District) (Prohibition of Waiting, Loading and Stopping) and (On-Street Parking Places) (Civil Enforcement Area) Order 2020 to append the items set out in Schedule 2 of this notice.

This Order will be incorporated into The Essex County Council (Braintree District) (Prohibition of Waiting, Loading and Stopping) and (On-Street Parking Places) (Civil Enforcement Area) Consolidation Order 2019 by replacing tile numbers TL745 230 to rev 1, TL775 217 to rev 1, TL790 117 to rev 1, TL815 155 to rev 1, TL820 147 to rev 1, TL860 190 to rev 1, TL860 285 to rev 1 and TL860 287 to rev 1.

Further Details: A copy of the proposed Order with plans showing the specified lengths of roads, a Statement of Reasons for proposing to make the Orders and a copy of the Order to be amended may be inspected during normal office hours at Essex Highways, County Hall, Chelmsford, CM1 1QH, Braintree District Council, Causeway House, Bocking End, Braintree, CM7 9HB, or at <https://nepp.essexworkstraffweb.org.uk/consult/main.html> (BDC4) or at <http://www1.parkingpartnership.org/north/policies-troposals>

Objections: Anyone who wishes to object to the proposed Orders should send their grounds for objection in writing at <https://nepp.essexworkstraffweb.org.uk/consult/main.html> or to TRO Comments, North Essex Parking Partnership, PO Box 5575, Colchester, CO1 9LT by Monday 20th April 2020.

Date: Thursday 26th March 2020.

Richard Walker, Parking Partnership Group Manager, Colchester Borough Council, Rowan House, 33 Sheepen Road, Colchester, CO3 3WG

Schedule 1

Permit Parking

Column 1 Permit Identifier	Column 2 Type of Parking Control	Column 3 Area Name	Column 4 Days of Operation	Column 5 Hours of Operation (Permitted Hours)
K4	Permit Parking or Permit Parking Area	Zone K4	As Zone A	As Zone A
RR1	Permit Parking or Permit Parking Area	Zone RR1	As Zone A	As Zone A

Schedule 2

Residential property addresses that are eligible to apply for Resident and Visitor Permits:

Column 1	Column 2	Column 3	Column 4
Permit Zones	Roads	Properties Eligible	Resident Qualification
Zone K4	Bellingham Place	All Odd	All Even
Zone RR1	Rayne Road	All Odd	All Even
			See Schedule 5 notes
			See Schedule 5 notes

The Essex County Council (Braintree District) (Prohibition of Waiting, Loading and Stopping) and (On-Street Parking Places) (Civil Enforcement Area) (Amendment No.4) Order 202*

WHEREAS the Essex County Council in exercise of its powers under Sections 1(1), 2(1) to (3), 4(1), 4(2), 32, 35, 45, 46, 49 and 53 of and Part IV of Schedule 9 to the Road Traffic Regulation Act 1984 ("the Act") and of all other enabling powers and after consultation with the Chief Officer of Police in accordance with Part III of Schedule 9 to the Act hereby makes the following Order:-

1. The Essex County Council (Braintree District) (Prohibition of Waiting, Loading and Stopping) and (On-Street Parking Places) (Civil Enforcement Area) (Amendment No.*) Order 202* and shall come into operation on XX XX XX.
2. This Order will be incorporated into The Essex County Council (Braintree District) (Prohibition of Waiting, Loading and Stopping) and (On-Street Parking Places) (Civil Enforcement Area) Consolidation Order 2019 'the 2019 Order' by replacing the following Map Tiles;

TL745 230 revision 0 replaced by TL745 230 revision 1
TL775 217 revision 0 replaced by TL775 217 revision 1
TL790 117 revision 0 replaced by TL790 117 revision 1
TL815 155 revision 0 replaced by TL815 155 revision 1
TL820 147 revision 0 replaced by TL820 147 revision 1
TL860 190 revision 0 replaced by TL860 190 revision 1
TL860 285 revision 0 replaced by TL860 285 revision 1
TL860 287 revision 0 replaced by TL860 287 revision 1
3. The Map Schedule Legend to this Order only applies to the Map Tiles listed in this Order.
4. The prohibitions and restrictions imposed by this Order shall be in addition to and not in derogation from any restrictions or requirement imposed by regulations made or having effect as if made under the Act or by any other enactment.

Sealed with the Common Seal of the Essex County Council this XX day of XX Two Thousand and Twenty.

**THE COMMON SEAL OF ESSEX)
COUNTY COUNCIL was hereunto)
affixed in the presence of:-)**

The Essex County Council (Braintree District) (Prohibition of Waiting, Loading and Stopping) and (On-Street Parking Places) (Civil Enforcement Area) (Amendment Number 4) Order 202*

Statement of Reasons

The Street-Hatfield Peverel

The permanent order is required to keep the road free of parked vehicles where it is considered that any parking is inappropriate and likely to severely impede the access of large vehicles delivering to local businesses. Removing parked vehicles will allow the unhindered access to the service areas regularly utilised by delivery vehicles.

The Paddocks-Witham

The road is within walking distance of the train station and town centre and is regularly utilised by motorists wishing to avoid local car parking charges.

The permanent order is required to keep the road free of vehicles parking for an extensive duration, where it is considered that this parking is inappropriate and likely to severely impede the access of large vehicles. It will also prevent access issues for local residents.

Chippingdell-Witham

The permanent order is required to keep the road free of parked vehicles on a bend where any parking is a hindrance to traffic flow and access. The order will also serve to improve and preserve the amenities of the area through which the road runs.

Removing parked vehicles will also improve safety and reduce the probability of road traffic accidents and promote access to larger vehicles such as refuse freighters and those associated with the emergency services.

Bellingham Place-Kelvedon

The road is within short walking distance of the train station and is regularly utilised by non-residents and commuters wishing to avoid local car parking charges.

A permit parking scheme will improve the parking provision for households included in the scheme and their visitors by preventing non-residents from parking during the stipulated times.

Church Hill-Earls Colne

The road is within short walking distance of the primary School and is regularly utilised by motorists dropping off and collecting children at the applicable times. The introduction of additional double yellow lines in will ensure that access, flow of traffic and vision is un-obscured at key points, such as a junction, bend and roundabout. The provision of yellow lines will also reduce the probability of road traffic accidents and promote the access of larger vehicles.

Rayne Road-Braintree

The road is within short walking distance of the town centre and is regularly utilised by non-residents and those wishing to avoid local car parking charges. A permit parking scheme will improve the parking provision for households included in the scheme and their visitors by preventing non-residents from parking during the stipulated times.

Galleys Corner-Braintree

The permanent order is required to keep the road free of parked vehicles where it is considered that any parking is inappropriate and likely to severely impede the access of delivery vehicles and those associated with the emergency services. Removing parked vehicles at junctions will also improve safety and reduce the probability of road traffic accidents. The provision of limited waiting parking bays will provide parking places for those wishing to visit local businesses.

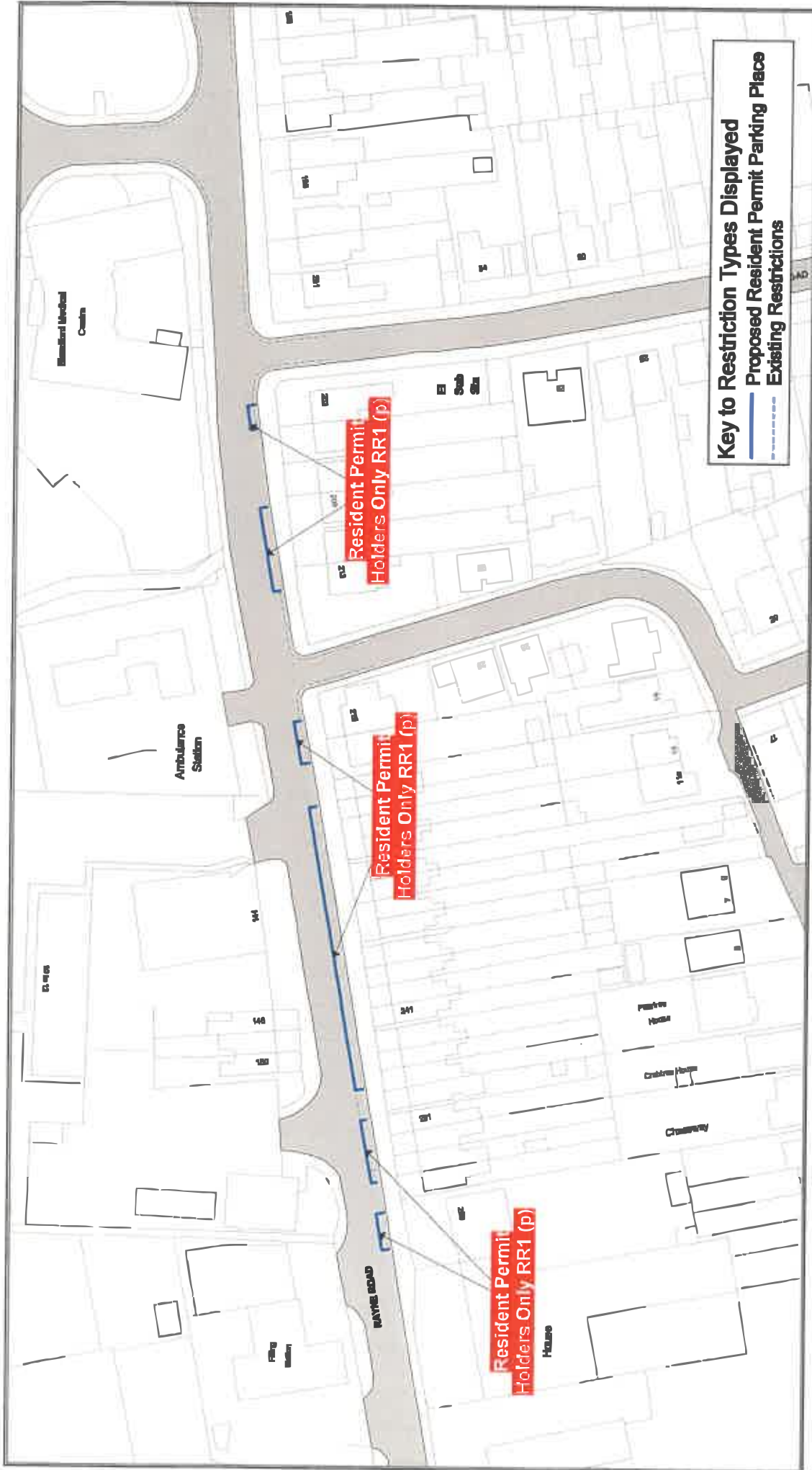

Key to Restriction Types Displayed
 — Proposed Resident Permit Parking Place
 - - - Existing Restrictions

Rayne Road	SCALE	1 : 1000
 Essex County Council	DATE	12/02/2020
	DRAWING No.	BT1_RR
 NORTH	DRAWN BY	BOM
	© Crown copyright. All rights reserved Essex County Council Licence No. LA 077070 2020	

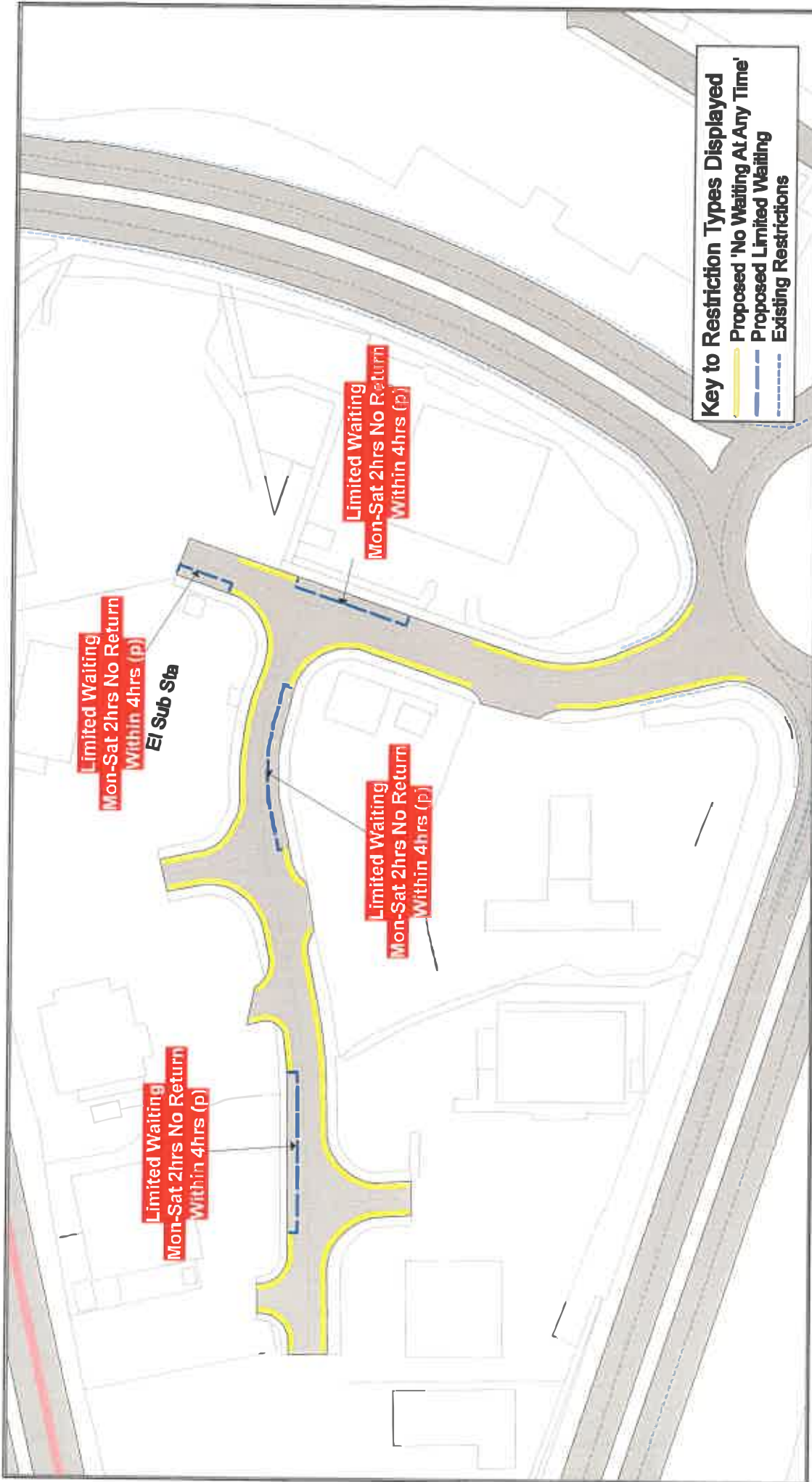

Key to Restriction Types Displayed
 Proposed 'No Waiting At Any Time'
 Proposed Limited Waiting
 Existing Restrictions

 Essex County Council	Galleys Corner	 NORTH	SCALE 1 : 1000
			DATE 31/01/2020
© Crown copyright. All rights reserved Essex County Council Licence No. LA 077070 2020	DRAWING No. BT1_GC	DRAWN BY BOM	SCALE 1 : 1000
	DRAWING No. BT1_GC	DRAWN BY BOM	DATE 31/01/2020

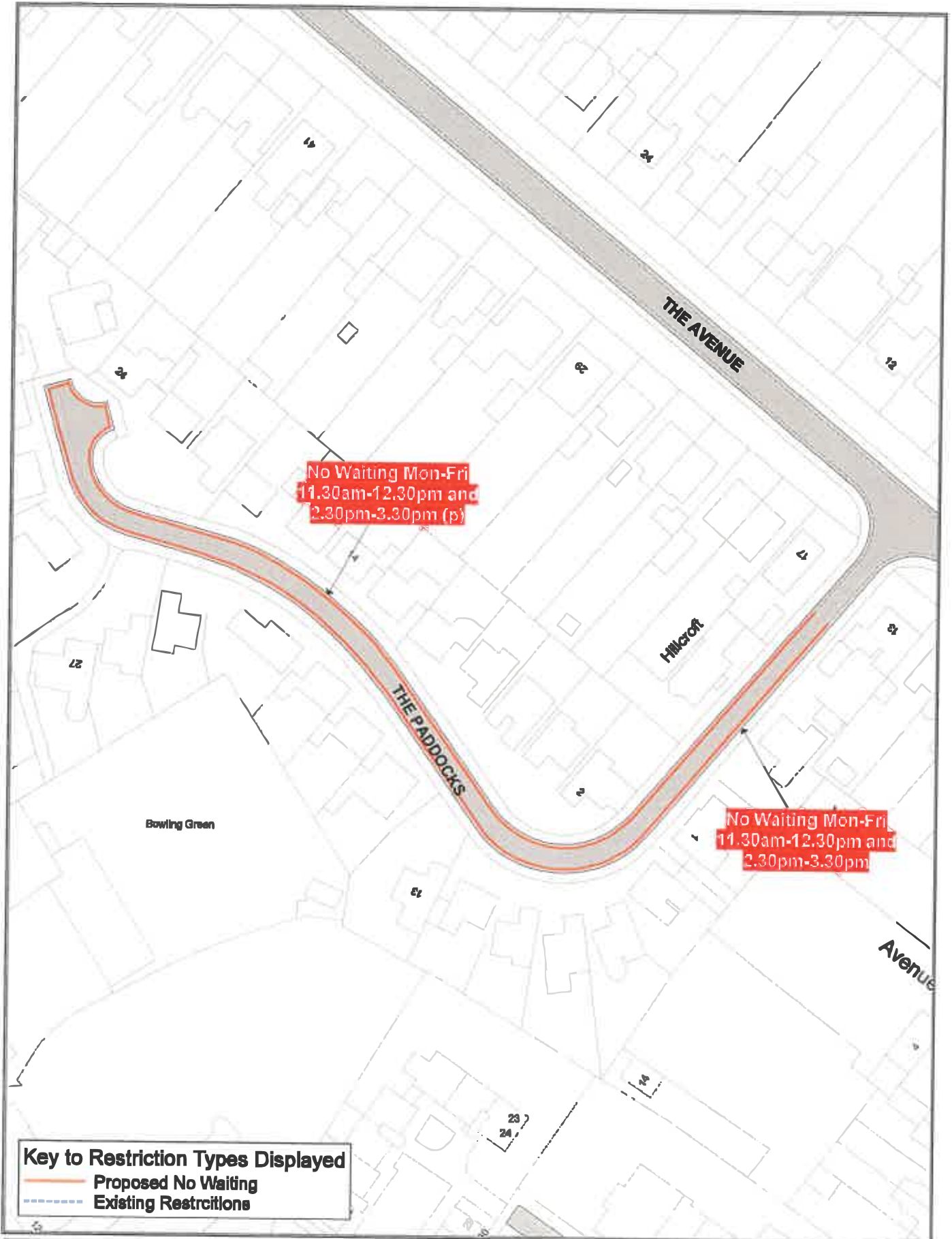

Key to Restriction Types Displayed

- Proposed No Waiting
- - - Existing Restrictions



The Paddocks



© Crown copyright. All rights reserved
 Essex County Council
 Licence No. LA 077070 2020

SCALE	1 : 1000
DATE	31/01/2020
DRAWING No.	BT1_TP
DRAWN BY	BOM

Key to Restriction Types Displayed
 — Proposed No Waiting At Any Time
 - - - Existing Restrictions

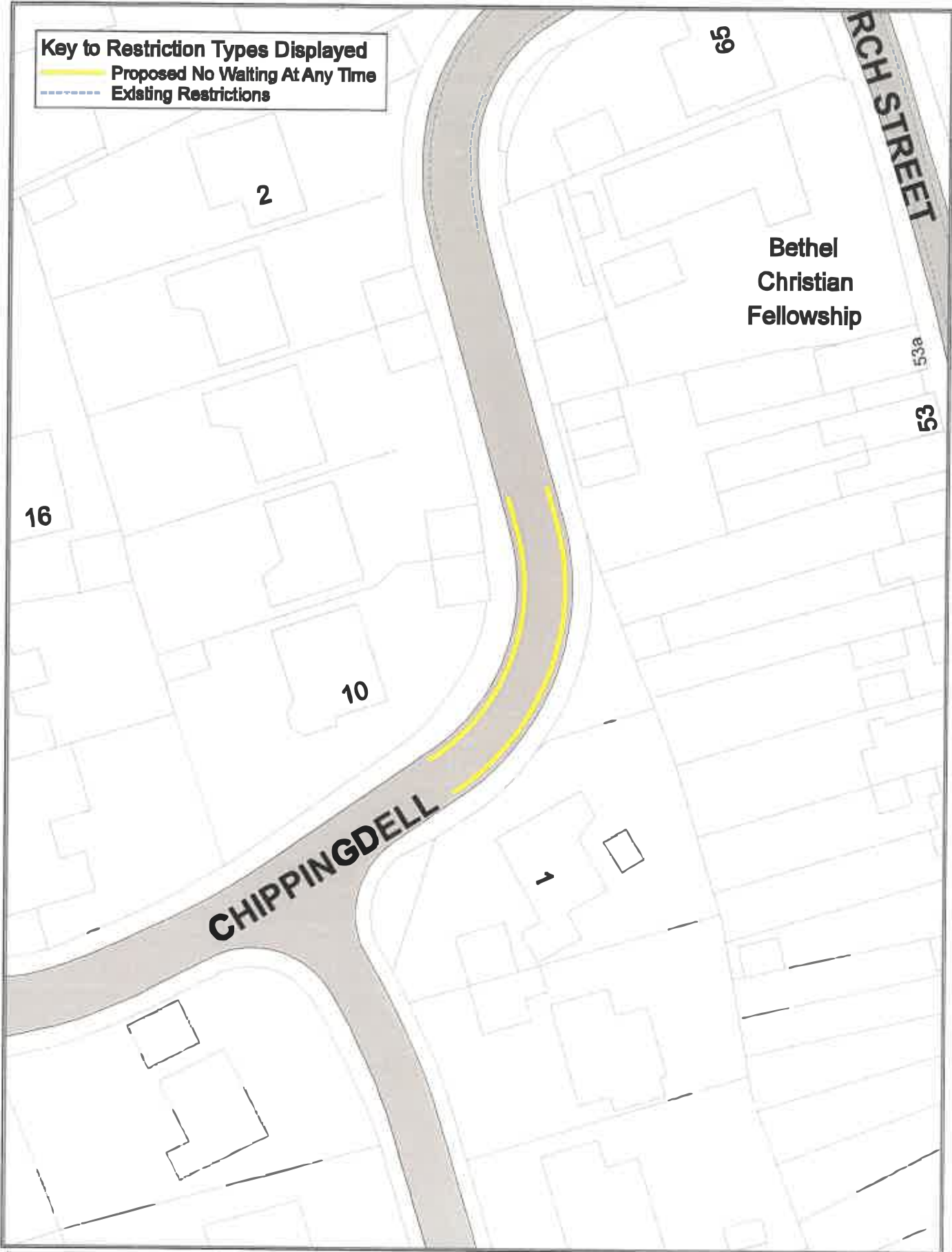

Chipping Dell



© Crown copyright. All rights reserved
 Essex County Council
 Licence No. LA 077070 2020

SCALE	1 : 500
DATE	31/01/2020
DRAWING No.	BT1_CD
DRAWN BY	BOM

Key to Restriction Types Displayed

-  Proposed 'No Waiting At Any Time'
-  Proposed Resident Permit Parking Place
-  Existing Restrictions

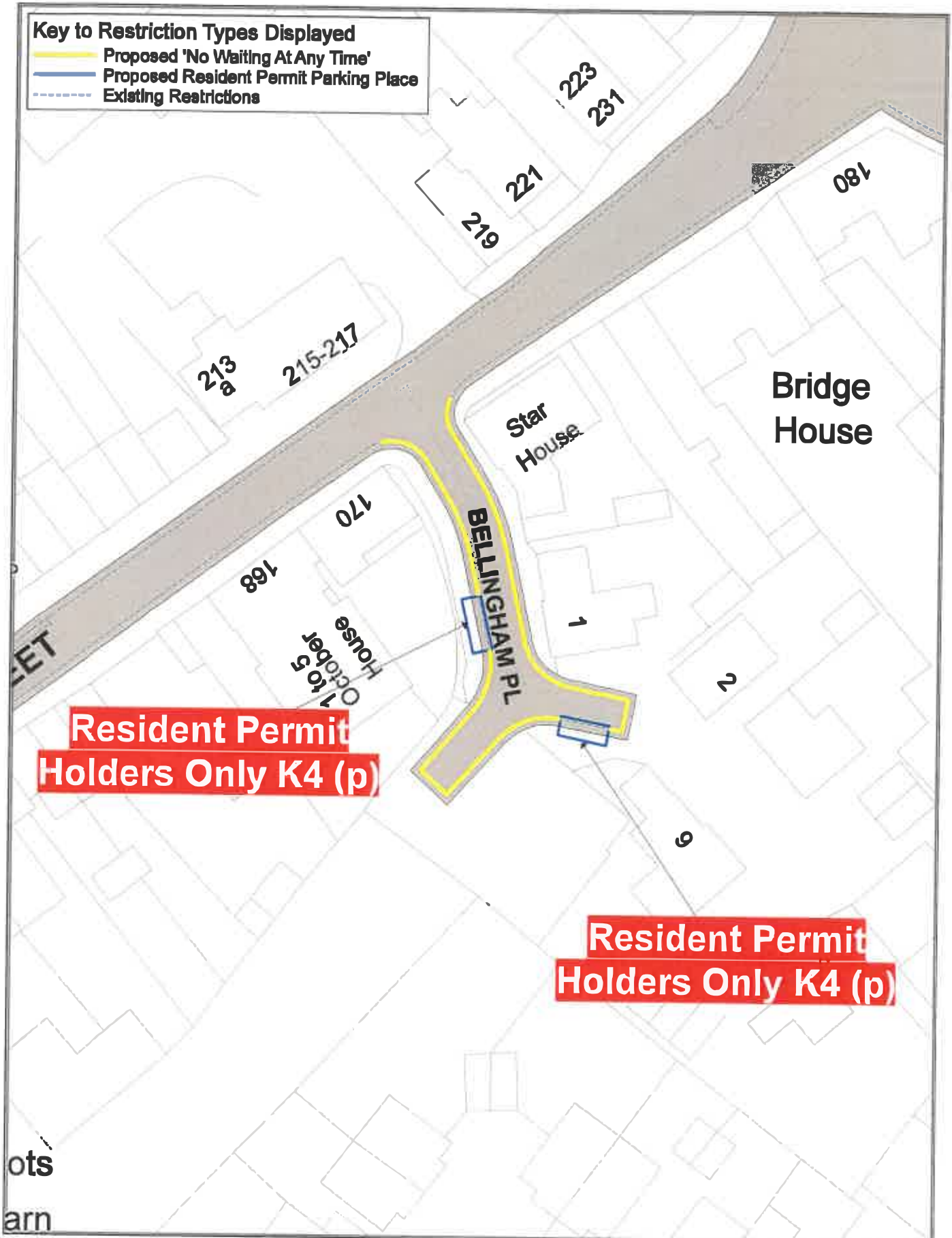

Resident Permit Holders Only K4 (p)

Resident Permit Holders Only K4 (p)



Bellingham Place



© Crown copyright. All rights reserved
 Essex County Council
 Licence No. LA 077070 2020

SCALE	1 : 500
DATE	31/01/2020
DRAWING No.	BT1_BP
DRAWN BY	BOM

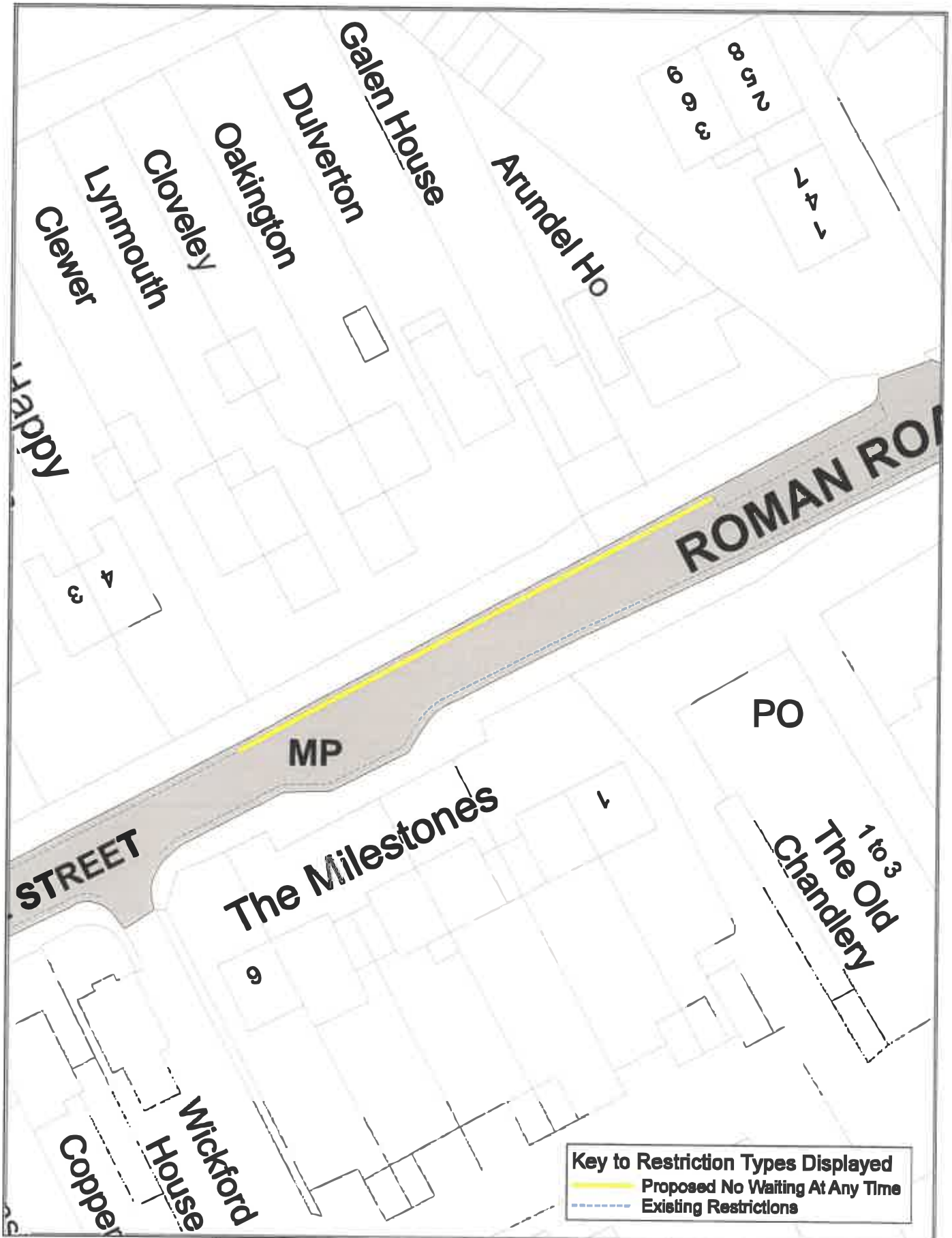

Key to Restriction Types Displayed
 ——— Proposed No Waiting At Any Time
 - - - Existing Restrictions



The Street



© Crown copyright. All rights reserved
 Essex County Council
 Licence No. LA 077070 2020

SCALE	1 : 500
DATE	31/01/2020
DRAWING No.	BT1_TS
DRAWN BY	BOM

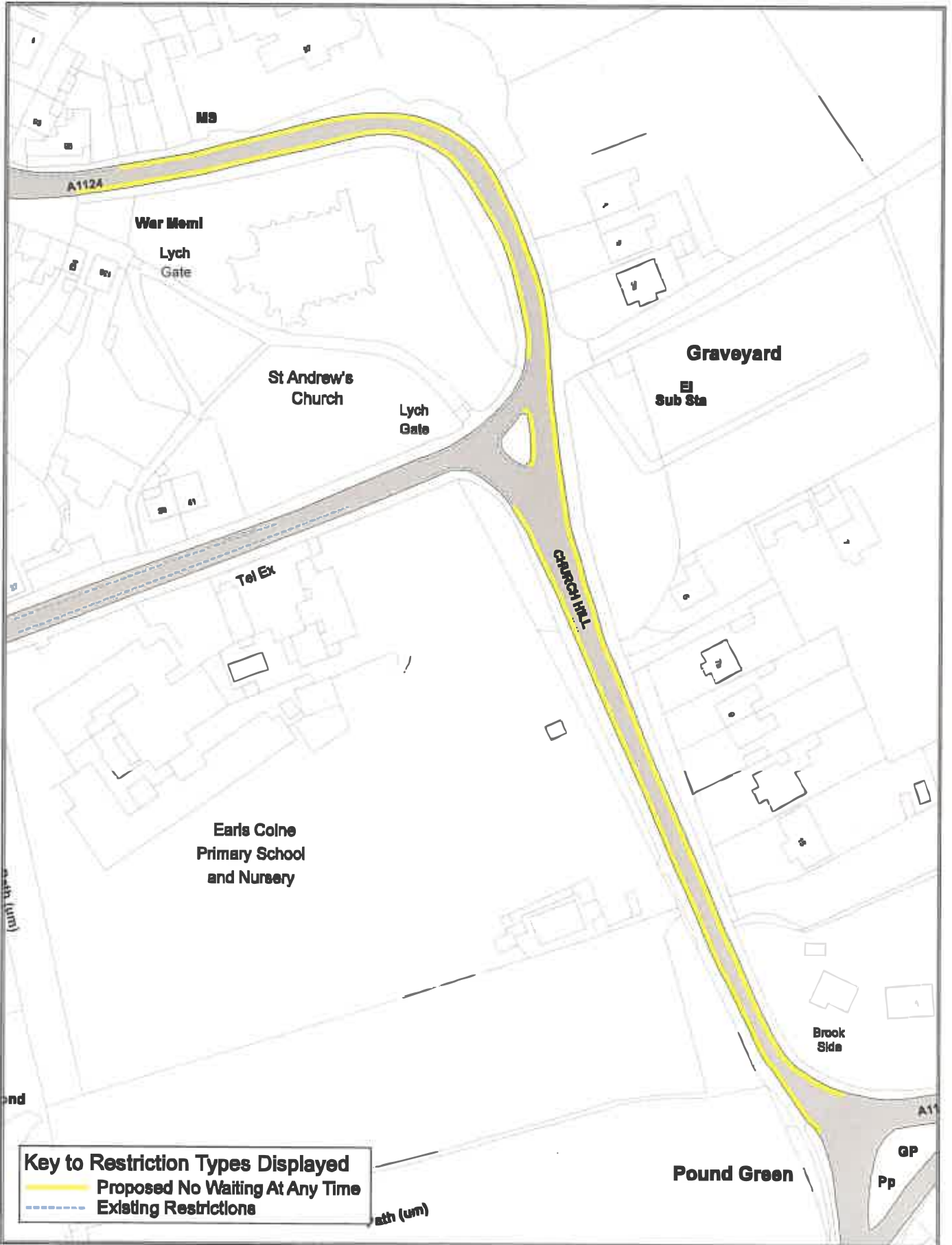

Key to Restriction Types Displayed
 ——— Proposed No Waiting At Any Time
 - - - Existing Restrictions



Church Hill



© Crown copyright. All rights reserved
 Essex County Council
 Licence No. LA 077070 2020

SCALE	1 : 1250
DATE	31/01/2020
DRAWING No.	BT1_CH
DRAWN BY	BOM