

The Essex County Council (Hatfield Forest Road) (Temporary Stopping Restriction) Order 2020

Notice is hereby given Colchester Borough Council acting on behalf of the North Essex Parking Partnership in exercise of the delegated powers of the traffic authority Essex County Council granted under an Agreement dated 31 March 2011 proposes to make a temporary Order under Sections 14(1) of the Road Traffic Regulation Act 1984

The effect of the Order: To temporarily replace current double yellow lines (No Waiting At Any Time) with double red lines (No Stopping At Any Time) on the entire lengths of Hatfield Forest Road and Bush End Road, and on each side of the junction with Hatfield Forest Road on The Street (B1256) in the district of Uttlesford.

Nothing in the Order shall apply to anything done with the permission or at the direction of a police constable in uniform or a Civil Enforcement Officer.

Nothing in the Order shall apply to any emergency vehicles.

The Order is proposed come into operation on 29 June 2020 to remain in force for a period of up to 18 months.

Date: 18 June 2020

Richard Walker, Parking Partnership Group Manager, Colchester Borough Council,
Rowan House, 33 Sheepen Road, Colchester, CO3 3WG

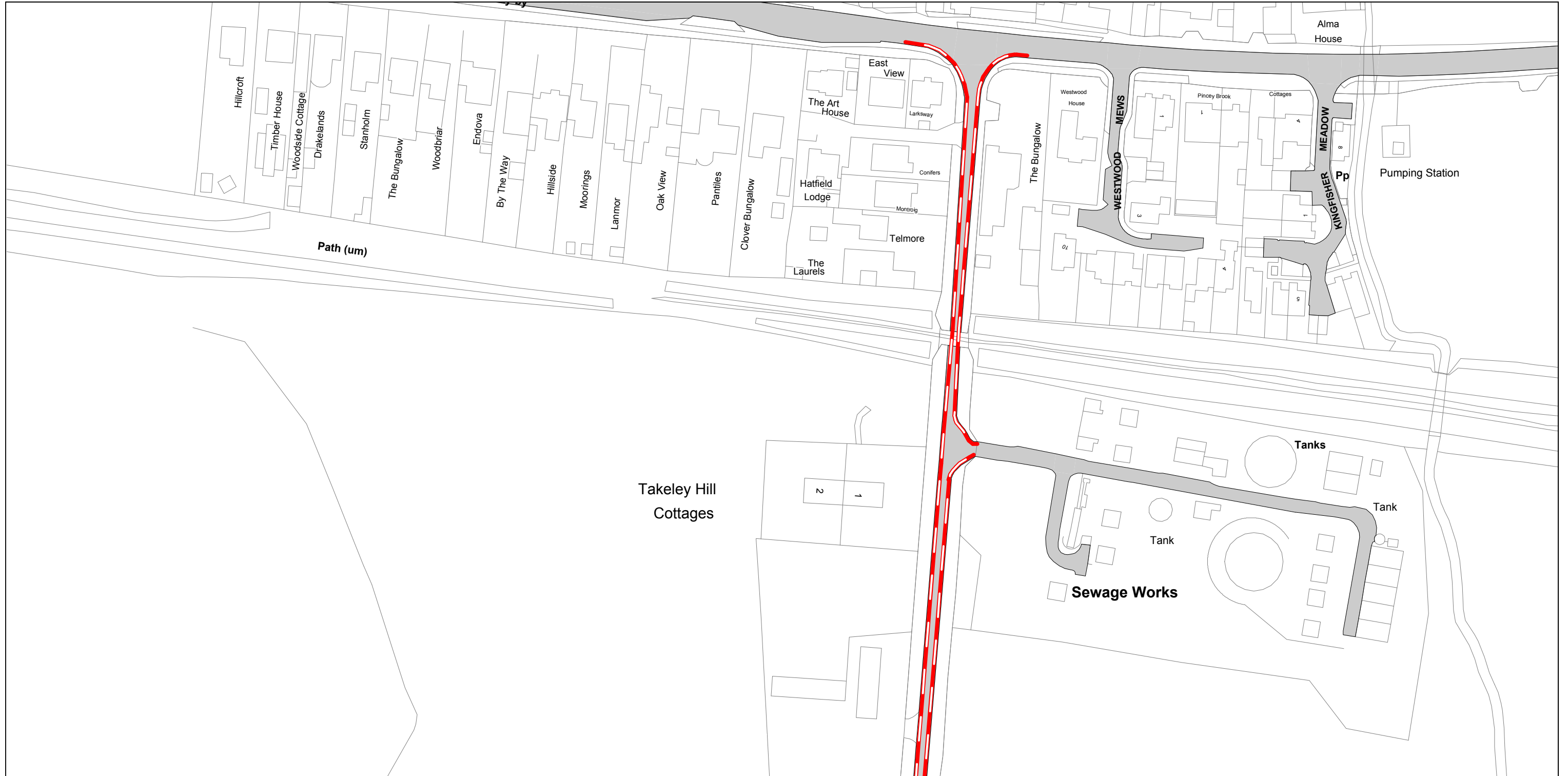

SEE STATIC MAP SCHEDULE LEGEND FOR RESTRICTIONS DISPLAYED



PROPOSED

Scale - 1 : 1250

@ A3

0

Metres

100

Title - North Essex Partnership -Street Waiting, Loading and Parking Plans

Produced from Ordnance Survey 1:1250 mapping with permission of the Controller of Her Majesty's Stationary Office (c) Crown Copyright Licence No. 100019602.
Unauthorised reproduction infringes Crown Copyright and may lead to prosecution or Civil Proceedings

This copy has been made by or with the authority of the Head of Legal Services of Essex County Council, pursuant of section 47 of the Copyright, Designs and Patents Act 1988 ('the Act'). Unless the Act provides a relevant exception to copyright, the copy must not be copied without the prior permission of the copyright owner.



SEE STATIC MAP SCHEDULE LEGEND FOR RESTRICTIONS DISPLAYED



PROPOSED

Scale - 1 : 1250 @ A3  0 Metres 100

Title - North Essex Partnership -Street Waiting, Loading and Parking Plans

Produced from Ordnance Survey 1:1250 mapping with permission of the Controller of Her Majesty's Stationary Office (c) Crown Copyright Licence No. 100019602. Unauthorised reproduction infringes Crown Copyright and may lead to prosecution or Civil Proceedings

This copy has been made by or with the authority of the Head of Legal Services of Essex County Council, pursuant of section 47 of the Copyright, Designs and Patents Act 1988 ('the Act'). Unless the Act provides a relevant exception to copyright, the copy must not be copied without the prior permission of the copyright owner.

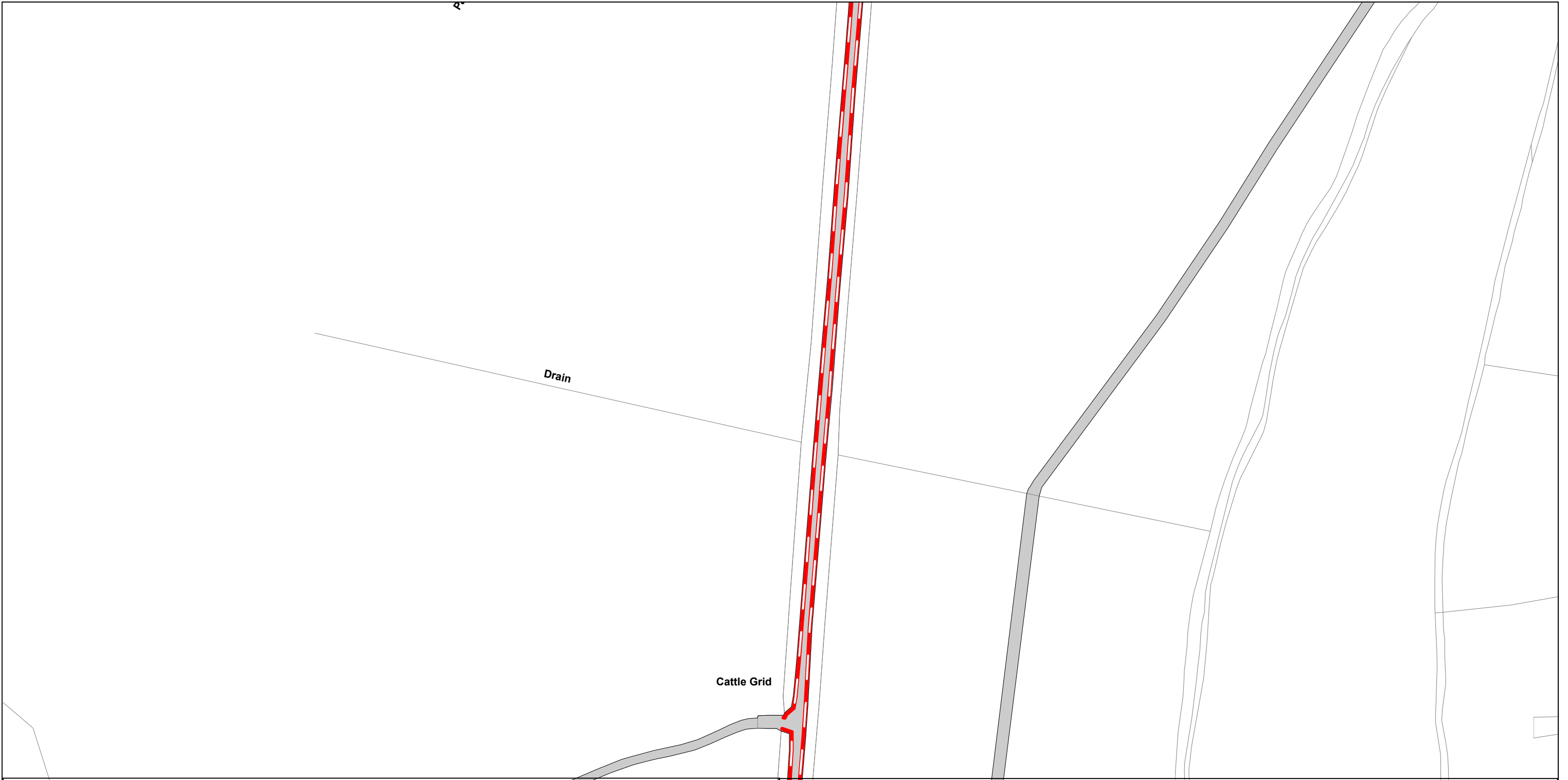

SEE STATIC MAP SCHEDULE LEGEND FOR RESTRICTIONS DISPLAYED



PROPOSED

Scale - 1 : 1250

@ A3



Title - North Essex Partnership -Street Waiting, Loading and Parking Plans

Produced from Ordnance Survey 1:1250 mapping with permission of the Controller of Her Majesty's Stationary Office (c) Crown Copyright Licence No. 100019602. Unauthorised reproduction infringes Crown Copyright and may lead to prosecution or Civil Proceedings

This copy has been made by or with the authority of the Head of Legal Services of Essex County Council, pursuant of section 47 of the Copyright, Designs and Patents Act 1988 ('the Act'). Unless the Act provides a relevant exception to copyright, the copy must not be copied without the prior permission of the copyright owner.

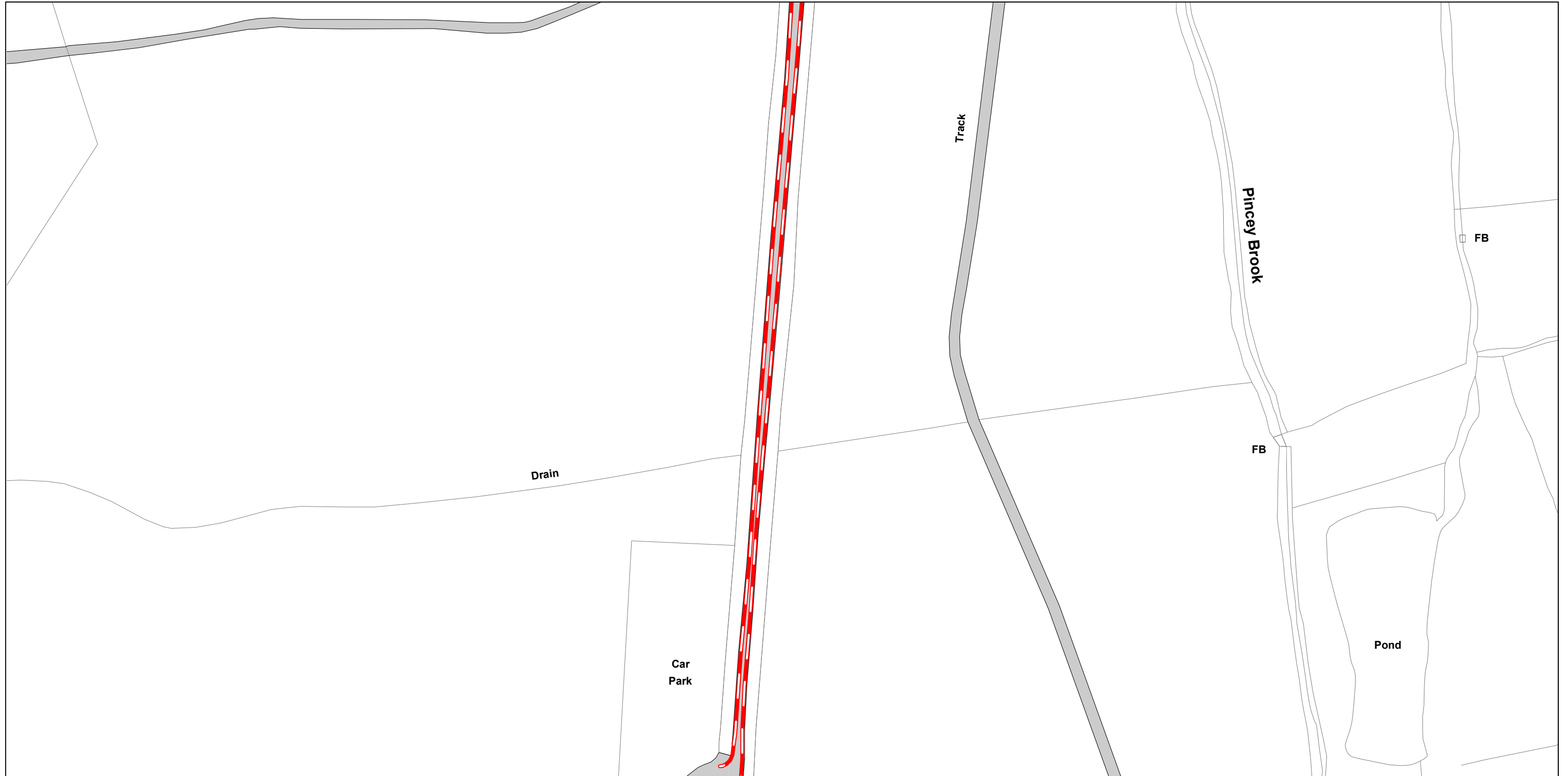

SEE STATIC MAP SCHEDULE LEGEND FOR RESTRICTIONS DISPLAYED



PROPOSED

Scale - 1 : 1250 @ A3  Metres 100

Title - North Essex Partnership -Street Waiting, Loading and Parking Plans

Produced from Ordnance Survey 1:1250 mapping with permission of the Controller of Her Majesty's Stationary Office (c) Crown Copyright Licence No. 100019602. Unauthorised reproduction infringes Crown Copyright and may lead to prosecution or Civil Proceedings

This copy has been made by or with the authority of the Head of Legal Services of Essex County Council, pursuant of section 47 of the Copyright, Designs and Patents Act 1988 ('the Act'). Unless the Act provides a relevant exception to copyright, the copy must not be copied without the prior permission of the copyright owner.

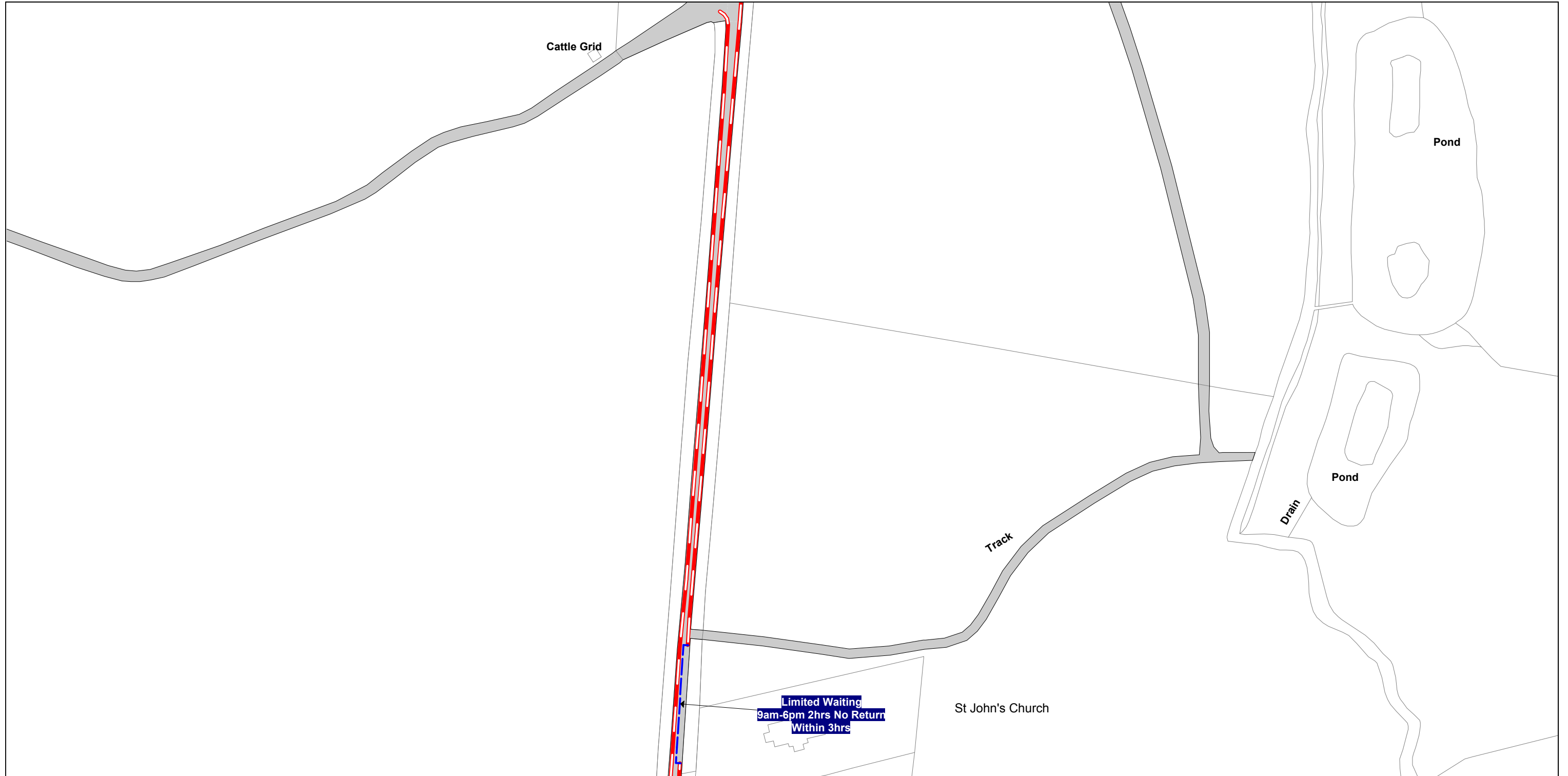

SEE STATIC MAP SCHEDULE LEGEND FOR RESTRICTIONS DISPLAYED



PROPOSED

Scale - 1 : 1250

@ A3



Title - North Essex Partnership -Street Waiting, Loading and Parking Plans

Produced from Ordnance Survey 1:1250 mapping with permission of the Controller of Her Majesty's Stationary Office (c) Crown Copyright Licence No. 100019602. Unauthorised reproduction infringes Crown Copyright and may lead to prosecution or Civil Proceedings

This copy has been made by or with the authority of the Head of Legal Services of Essex County Council, pursuant of section 47 of the Copyright, Designs and Patents Act 1988 ('the Act'). Unless the Act provides a relevant exception to copyright, the copy must not be copied without the prior permission of the copyright owner.

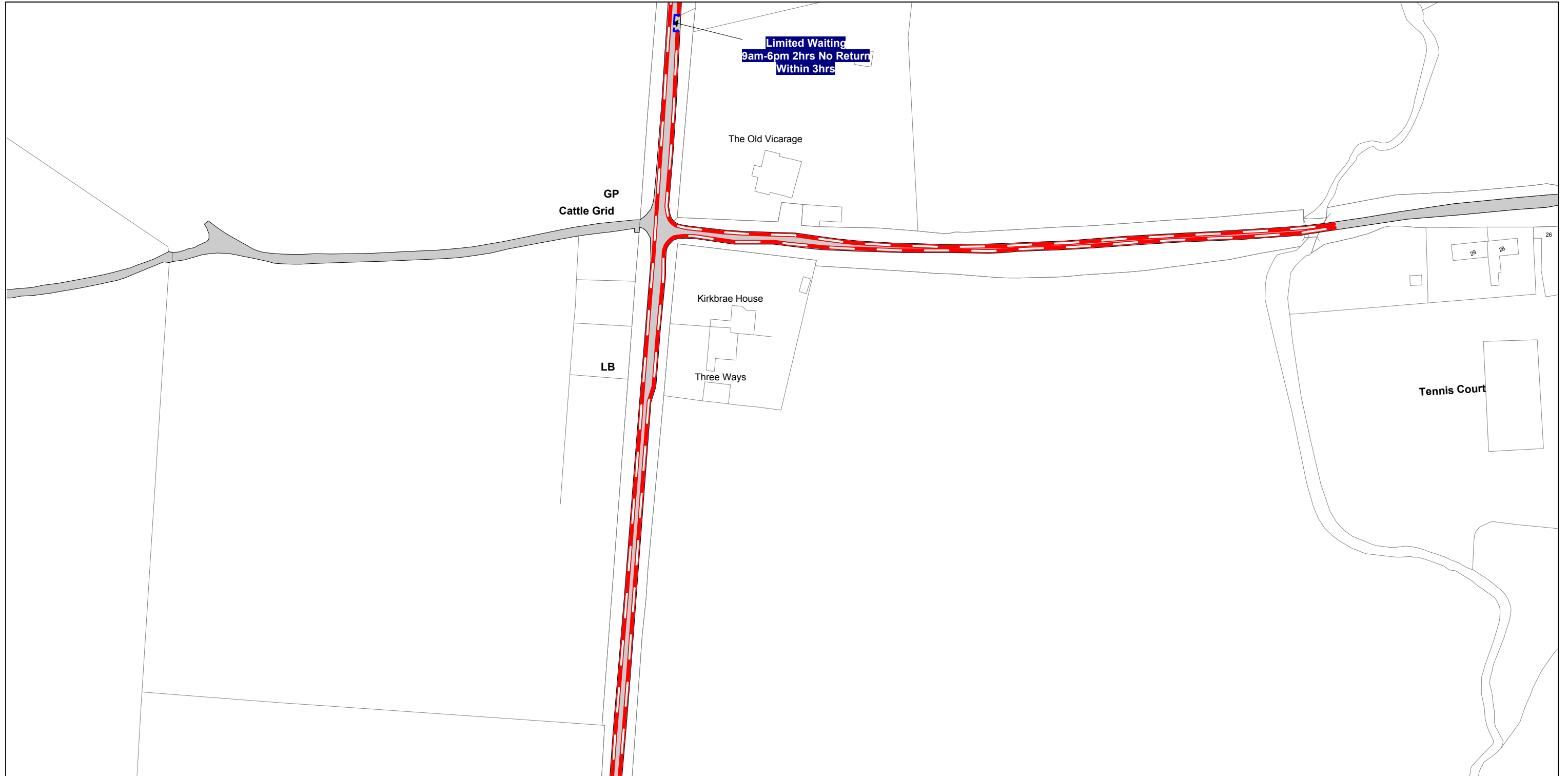

SEE STATIC MAP SCHEDULE LEGEND FOR RESTRICTIONS DISPLAYED



PROPOSED

Scale - 1 : 1250 @ A3

Title - North Essex Partnership -Street Waiting, Loading and Parking Plans

Produced from Ordnance Survey 1:1250 mapping with permission of the Controller of Her Majesty's Stationary Office (c) Crown Copyright Licence No. 100019602. Unauthorised reproduction infringes Crown Copyright and may lead to prosecution or Civil Proceedings

This copy has been made by or with the authority of the Head of Legal Services of Essex County Council, pursuant of section 47 of the Copyright, Designs and Patents Act 1988 ('the Act'). Unless the Act provides a relevant exception to copyright, the copy must not be copied without the prior permission of the copyright owner.

Tile Reference:

TL545 195



The North Essex Parking Partnership
PO Box 5575
Town Hall
Colchester
CO1 9LT



Essex County Council
County Hall
Chelmsford
Essex

Sheet Revision Number: 1

Sheet Active From: 29/05/2020

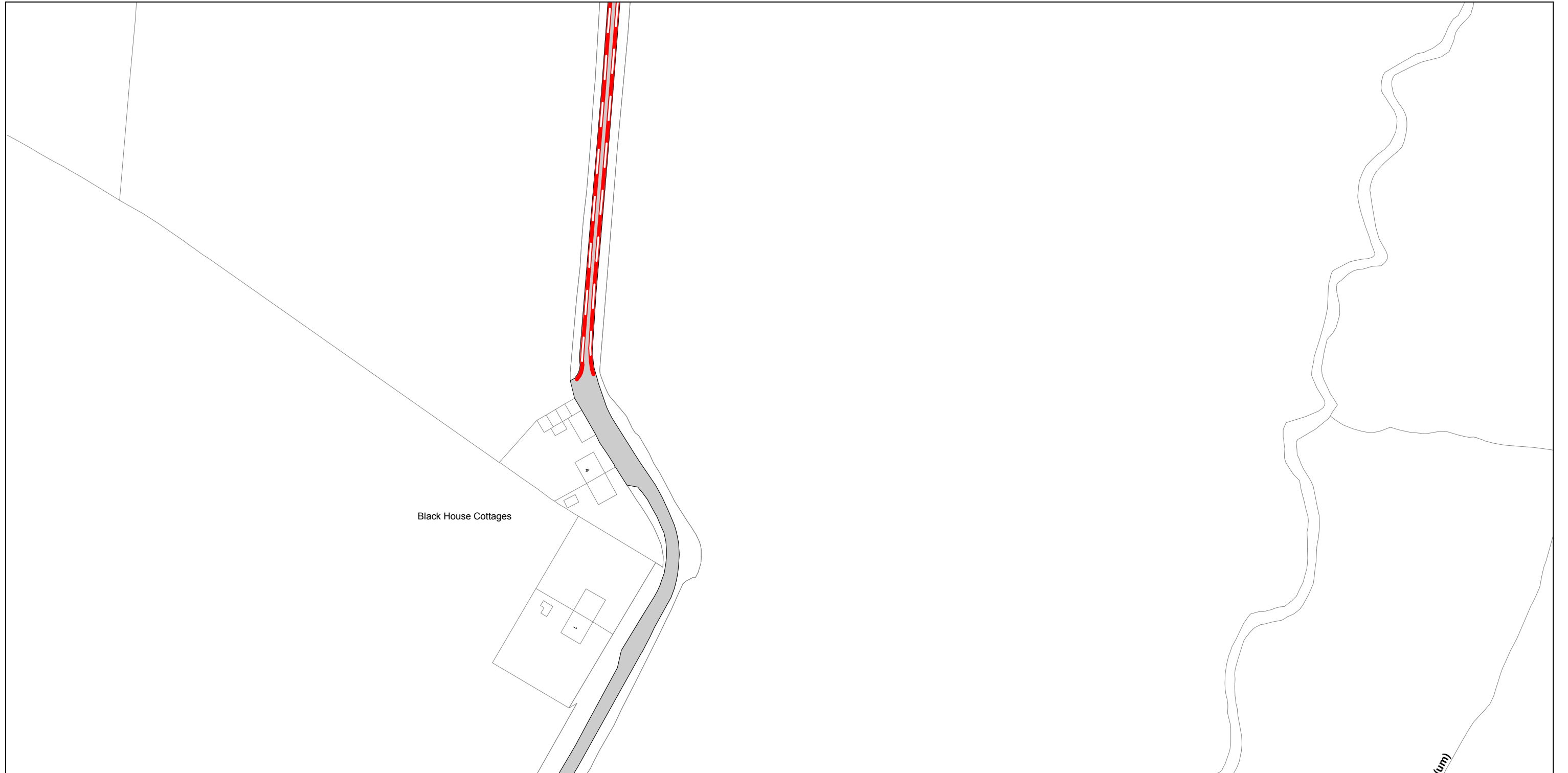

SEE STATIC MAP SCHEDULE LEGEND FOR RESTRICTIONS DISPLAYED



PROPOSED

Scale - 1 : 1250 @ A3  0 Metres 100

Title - North Essex Partnership -Street Waiting, Loading and Parking Plans

Produced from Ordnance Survey 1:1250 mapping with permission of the Controller of Her Majesty's Stationary Office (c) Crown Copyright Licence No. 100019602. Unauthorised reproduction infringes Crown Copyright and may lead to prosecution or Civil Proceedings

This copy has been made by or with the authority of the Head of Legal Services of Essex County Council, pursuant of section 47 of the Copyright, Designs and Patents Act 1988 ('the Act'). Unless the Act provides a relevent exception to copyright, the copy must not be copied without the prior permission of the copyright owner.