

The Essex County Council (Uttlesford District) (Prohibition of Waiting, Loading and Stopping) and (On-Street Parking Places) (Civil Enforcement Area) (Amendment No.27) Order 2024

Notice is hereby given Colchester City Council acting on behalf of the North Essex Parking Partnership in exercise of the delegated powers of the traffic authority Essex County Council granted under an Agreement dated 1st July 2022 proposes to make the above Order under Sections 1(1), 2(1) to (3), 4 (1), 4(2), 32, 35,45,46,49 and 53 and Parts III and IV of schedule 9 of the Road Traffic Regulation Act 1984

The effect of the Order:

1. To introduce 'No Waiting / Stopping at any time' Red route -B1256/The Pastures, Takeley. Double red route on the north side of the B1256 opposite its junction with The Pastures. On its south side at the junction with The Pastures for approximately 26 metres extending into The Pastures on its West side and 27 metres on its East side.
2. To revoke sections of the No waiting Mon-Fri 10am – 11am at the junction of The Pastures and B1256 for a distance of approximately 18metres on both East and West side (replaced by red route at point 1.)
3. To introduce 'No waiting/Stopping at any time' red route for a distance of on the south of the B1057 (Lime Tree Hill where it meets Church street) Dunmow for approximately 60 metres west along Lime Tree Hill. On the North of B1057 opposite the Angel & Harp Public house for approximately 75 metres West along Lime Tree Hill.

This Order will be incorporated into The Essex County Council (Uttlesford District) (Prohibition of Waiting, Loading and Stopping) and (On-Street Parking Places) (Civil Enforcement Area) Consolidation Order 2019 by replacing tile numbers TL555 212 TL555 210, TL560 212 and TL625 227 Revision 0 with TL555 212 TL555 210, TL560 212 and TL625 227 revision 1.

Further Details: A copy of the proposed Order with plans showing the specified lengths of roads, a Statement of Reasons for proposing to make the Orders and a copy of the Order to be amended may be viewed at <https://nepp.traffweb.app/traffweb/2/PublicConsultation>

Objections: Anyone who wishes to object to the proposed Orders should send their grounds for objection in writing at <https://nepp.traffweb.app/traffweb/2/PublicConsultation> or to TRO Comments, North Essex Parking Partnership, PO Box 5575, Colchester, CO1 9LT by 28th April 2024.

Date: 4th April 2024

Richard Walker, Head of Parking, Colchester City Council,
Rowan House, 33 Sheepen Road, Colchester, CO3 3WG

The Essex County Council (Uttlesford District) (Prohibition of Waiting, Loading and Stopping) and (On-Street Parking Places) (Civil Enforcement Area) (Amendment No.27) Order 2024

WHEREAS Colchester City Council acting on behalf of the North Essex Parking Partnership in exercise of the delegated powers of the traffic authority Essex County Council granted under an Agreement dated 1st July 2022 in exercise of its powers under Sections 1(1), 2(1) to (3), 4(1), 4(2), 32, 35, 45, 46, 49 and 53 of and Part IV of Schedule 9 to the Road Traffic Regulation Act 1984 (“the Act”) and of all other enabling powers and after consultation with the Chief Officer of Police in accordance with Part III of Schedule 9 to the Act hereby makes the following Order:-

1. The Essex County Council (Uttlesford District) (Prohibition of Waiting, Loading and Stopping) and (On-Street Parking Places) (Civil Enforcement Area) (Amendment No.27) Order 2024 and shall come into operation on xxxxxxxx.
2. This Order will be incorporated into The Essex County Council (Uttlesford District) (Prohibition of Waiting, Loading and Stopping) and (On-Street Parking Places) (Civil Enforcement Area) Consolidation Order 2019 ‘the 2019 Order’ by:
 - a. replacing the following Map Tiles:

TL555 212 revision 0 replaced by TL555 212 revision 1
TL555 210 revision 0 replaced by TL555 210 revision 1
TL625 227 revision 0 replaced by TL625 227 revision 1
TL560 212 revision 0 replaced by TL560 212 revision 1
3. The prohibitions and restrictions imposed by this Order shall be in addition to and not in derogation from any restrictions or requirement imposed by regulations made or having effect as if made under the Act or by any other enactment.

Sealed with the Common Seal of the Colchester City Council this xxxx day of xxxxxx Two Thousand and Twenty-Four.

THE COMMON SEAL OF COLCHESTER CITY COUNCIL was hereunto)
affixed in the presence of:-

The Essex County Council (Uttlesford District) (Prohibition of Waiting, Loading and Stopping) and (On-Street Parking Places) (Civil Enforcement Area) (Amendment No.UDC.27) Order 2024.

B1057/Lime Tree Hill, Dunmow

The B1057 carries a significant volume of vehicular traffic through Dunmow. Where Lime Tree Hill meets Church street the roads bends, the topography of the land and the properties situated at this location (Including the Angel & Harp PH) make this a 'blind bend'.

Footpaths are situated on both sides of the carriageway, however these are narrow. A public house is situated within Church street on its east side.

To the South of Lime Tree Hill is located a recreation ground which attracts visitors who often park vehicles along this stretch, reducing both the road and footpath width and creating hazards for both pedestrians and vehicles.

Parking within proximity of the bend is considered to cause a significant hazard to road users forcing vehicles into the centre of the carriageway approaching a blind bend. The nature of vehicles parking partially/completely obstructing the pavements at the location also force some pedestrians into the carriageway.

It is proposed to introduce 'No waiting/stopping at any time' Red route restrictions at the location to prevent parking on both sides of the B1057 Lime Tree Hill to improve the safety to road users and pedestrians.

The restrictions are intended to:

Provide increased safety for vehicles and pedestrians by improving sight lines for drivers and pedestrians.

To keep the roads free of parked vehicles where it is considered that any parking is inappropriate. Removing parked vehicles at the junction will also improve safety and reduce the probability of road traffic accidents. To avoid danger to persons or other traffic using the road or any other road or to prevent the likelihood of such danger arising. To facilitate the passage on the road or any other road of any class of traffic (including pedestrians).

B1256/ The Pastures, Takeley

The B1256 runs through the village of Takeley and carries a significant volume of local traffic. It is within close proximity of London Stansted airport and the area can attract visitors trying to avoid airport parking charges.

The area around the B1256 junction with The Pastures junction and Silver Jubilee Hall have been identified as locations that present a raised risk to road users due to reduced sight lines and narrowing of the carriageway due to parked vehicles.

The added risk to vehicles entering/exiting The Pastures and Silver Jubilee Hall has led to the proposal.

To reduce the risks to road users and pedestrians it is proposed to introduce 'No waiting/stopping at any time' red route at and opposite The Pastures junction with the B1256.

The permanent order is required for the safety of road users and pedestrians by preventing parking near to the junction.

The restriction near to the junction will provide increased safety for vehicles and pedestrians by improving sight lines for drivers and pedestrians.

To keep the roads free of parked vehicles where it is considered that any parking is inappropriate during these times. Removing parked vehicles at the junction will also improve safety and reduce the probability of road traffic accidents. To avoid danger to persons or other traffic using the road or any other road or to prevent the likelihood of such danger arising. To facilitate the passage on the road or any other road of any class of traffic (including pedestrians).



© Crown copyright. All rights reserved Essex County Council Licence No. LA 077070 2024		SCALE	1 : 1250
		DATE	14/03/2024
NEPP_UDC27_Lime Tree Hill		DRAWING No.	
		DRAWN BY	
 Essex County Council			

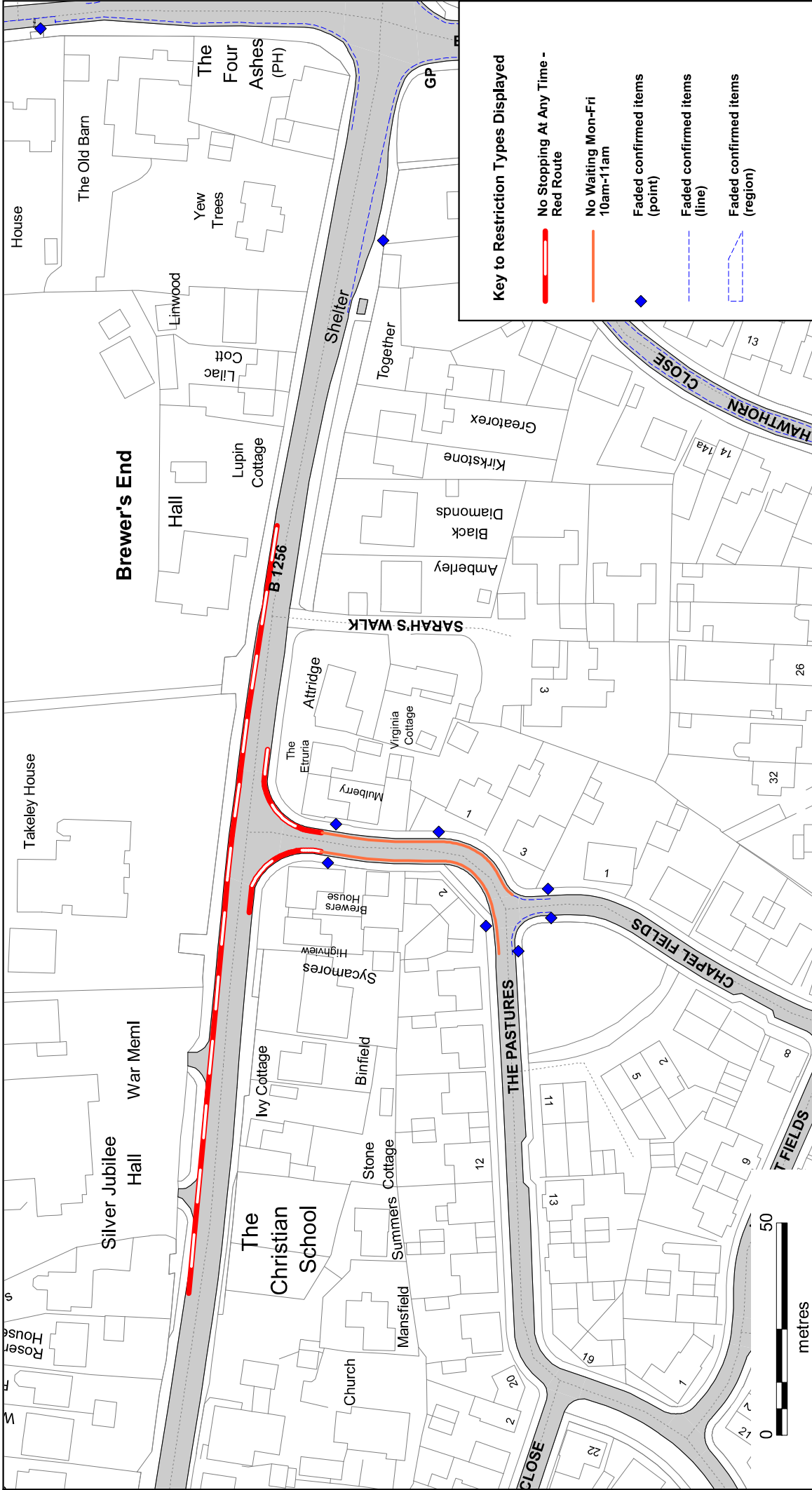

© Crown copyright. All rights reserved Essex County Council Licence No. LA 077070 2024	SCALE	1 : 1250
	DATE	20/02/2024
NEPP_UDC27_The Pastures	DRAWING No.	
	DRAWN BY	
 Essex County Council		